

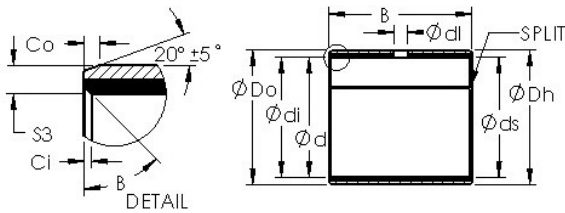

NTA PRECISION AXLE CORP.



AST AST50 44IB76 plain bearings

Bearing No. AST50 44IB76

Bore Diameter	69,85 mm
Bearing Type	straight
Shaft Dia., Nominal (d)	2.7500
Shaft Size (ds) - 2.75	2.7482
Housing Bore Dia. (Dh) - 2.937	2.9358
Bearing Bore after Mounting (di) - 2.7566	2.7502
Average Clearance (Cd)	0.0038
Wall Thickness (S3)	0.095
Bearing Length, Nominal (B)	4.750
Bearing Length Tolerance (B tol.) - +.010 / -0.010	+.010 / 0.010
OD Chamfer Length (Co)	0.072
ID Chamfer Angle (B deg.)	30
ID Chamfer Length (Ci)	0.031
Material	Carbon steel shell with PTFE / Fiber lining

AST50 44IB76 Bearing 2D drawings and 3D CAD models